

SEAWALL AT 6102 CAMINO DE LA COSTA  
SHOWING THE PROPOSED COLOR, TEXTURE AND  
SCULPTING PROPOSED

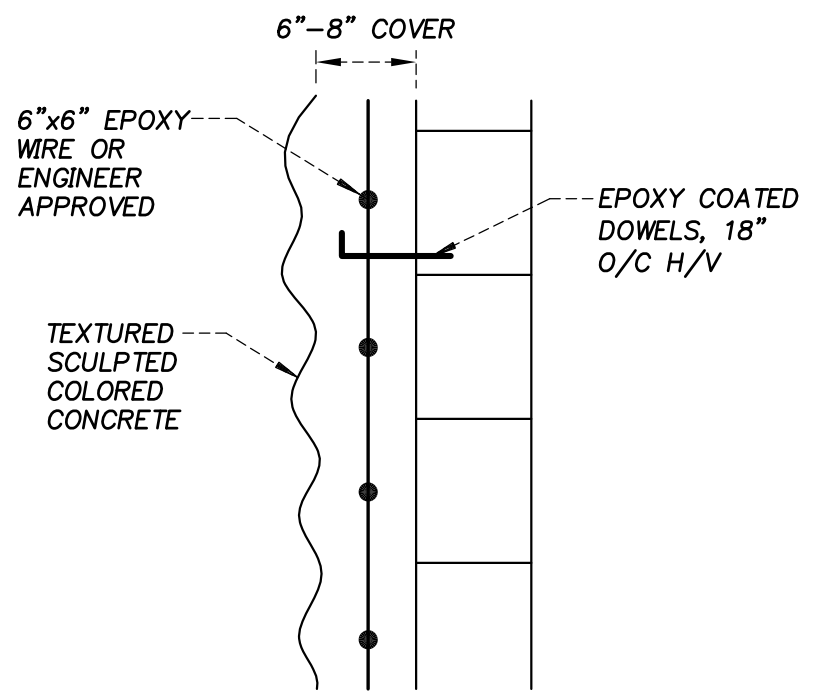

**DETAIL 'A'**

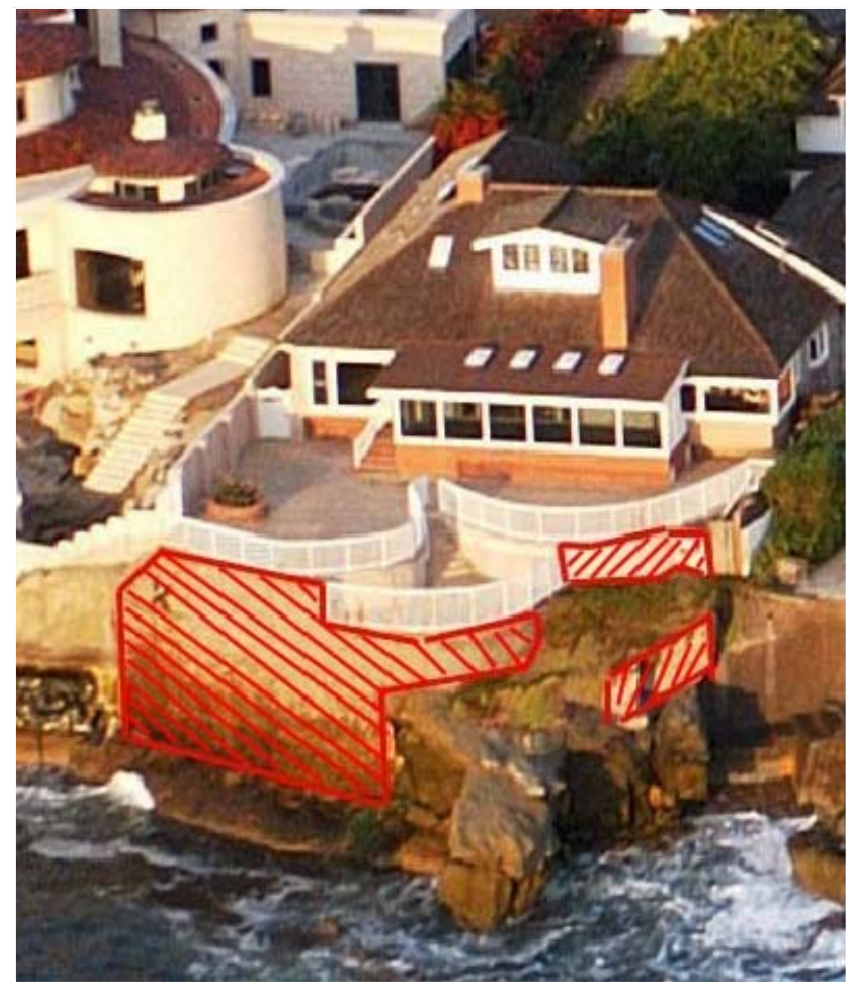

AREAS TO RECEIVE FACADE ARE CROSS HATCHED

DRAFTING BY:  
SCHMAHL DRAFTING  
DAVE SCHMAHL  
(760)414-3978



# SEAWALL MAINTENANCE

## 6010 Camino de la Costa

TITLE: SECTION VIEWS	
DRAWN:	SIGNED:
REV.	
REV.	
REV.	
REV.	
SIZE: B	SHEET 2 OF 2